

South 1/4 corner - Section 36, T6S, R10W, Tillamook County, Oregon.

Set 1" by 24" iron pipe for 1/4 corner, from which -----

A 24" Hemlock bears N07°00'E, a distance of 12.6 feet.  
Scribed 1/4 S 36 BT

A 16" Hemlock bears N40°00'W, a distance of 32.5 feet.  
Scribed 1/4 S 36 BT

Scribed by David L. Bowden  
Witnessed James M. Anliker  
August 28, 1961  
Var. 20°40'E

North 1/4 corner - Section 1, T6S, R10W, Tillamook County, Oregon.

Set 3/4" by 30" iron pipe for 1/4 corner, from which -----

A 10" Hemlock bears S32°00'W, a distance of 12.2 feet.  
Scribed 1/4 S 1 BT

A 8" Spruce bears S12°00'E, a distance of 14.1 feet.  
Scribed 1/4 S 1 BT

Scribed by David L. Bowden  
Witnessed James M. Anliker  
August 28, 1961  
Var. 20°40'E

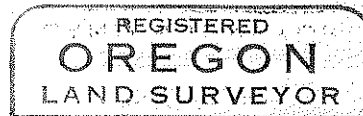

*David Lee Bowden*

